

designed for travel and living

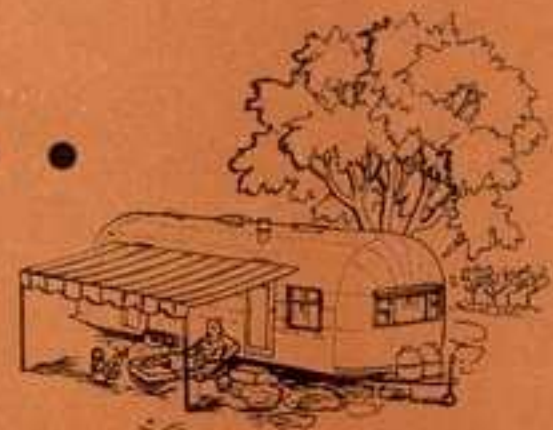

**ONE YEAR
WRITTEN
GUARANTEE**



THE LUXURIOUS

SILVER STREAM

The aristocrat of the travel trailers. All metal lightweight aircraft type construction - designed for travel and living.

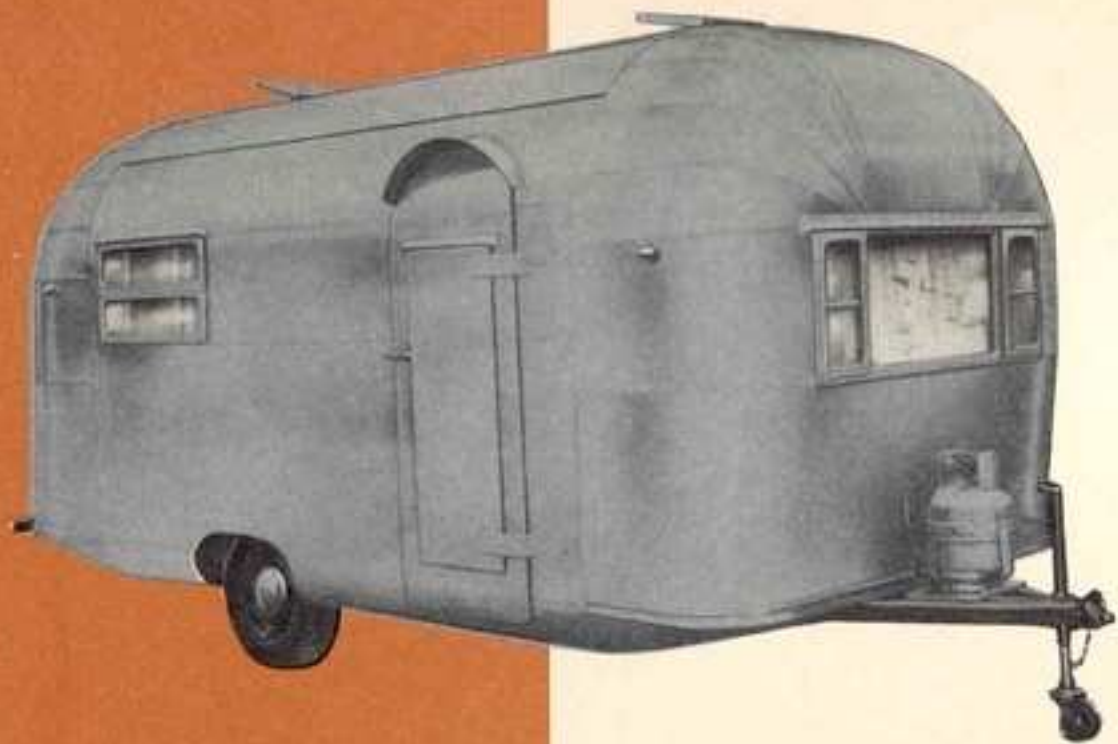

THE *Jet* 19'

STANDARD EQUIPMENT

Glass Lined Electric Hot Water Heater
 One 6-V Dome Light
 Apartment size stove with oven and broiler
 4-foot combination electric and ice refrigerator
 Linoleum floor covering
 Overhead cabinets with shelves
 Drapes with draw shades over sink
 18"x42" escape window in rear
 3" channel iron bumper
 Directional signal lights
 5/8" Plywood floor
 Insulation — Fibre glass
 .064 Extruded aluminum roof bows
 Toilet, shower and lavatory
 Medicine cabinet
 Double bed mattress only

Dinette, divan, or chairs in front
 Formica sink top and table top
 Recessed and vented wall heater
 All metal cabinets with wood doors
 Awning rail 11 feet
 Two roof vents
 One 35"x18" picture window
 Luggage compartment in rear
 Single butane tank with regulator
 7-way car connector
 Built-in step
 Electric brakes with break-away switch or hydraulic
 Heavy duty wheels with 6-ply tires
 Painted your choice of colors

SPECIFICATIONS

Overall length	19'
Body length	16'
Overall height	8' 9"
Overall body width	7' 4 1/2"
Inside height	6' 8"
Inside width	7' 1"
Overall weight	2400 lbs.
Hitch weight	180 lbs.



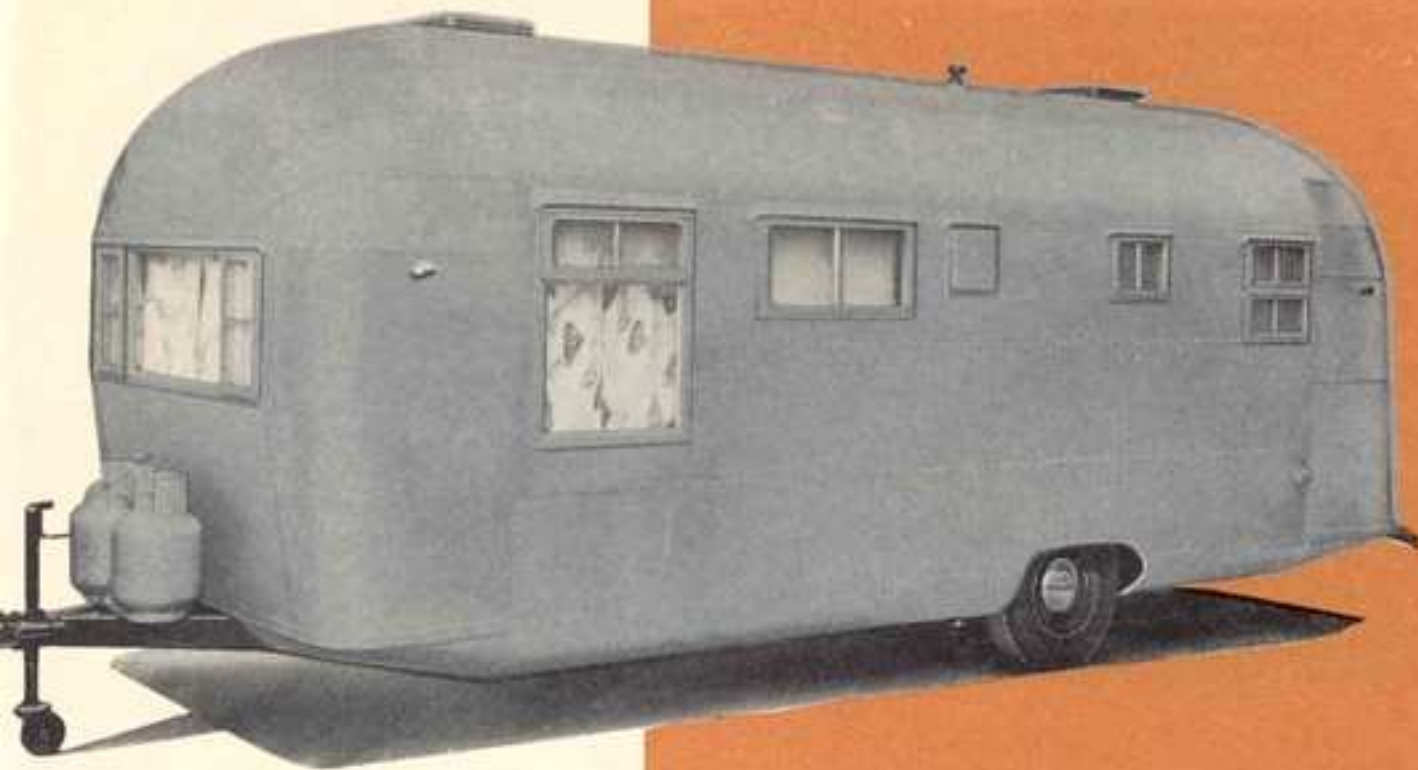

THE *Clipper* 23'

STANDARD EQUIPMENT

Double or twin beds—box springs and innerspring mattresses	Toilet, shower and lavatory
Divan with arms, dinette, or chairs in front	Medicine cabinet
Three-position table with formica top	Escape type rear window — 18"x42"
Formica sink top	Drapes with draw shades over sinks
Double sinks	15-foot awning rail
Glass lined electric hot water heater	One 6-volt dome light
Recessed and vented wall heater	Double butane tanks
Deluxe apartment size stove	Outside compartment door
Power wall fan above stove	3" channel iron bumper
Eight foot combination refrigerator	Electric brakes with break-away switch or hydraulic
All metal cabinets	Heavy duty wheels and 8-ply tires
Inlay linoleum	Built-in step
Directional signal lights	Glass-lined 14-gallon pressure water tank

SPECIFICATIONS

Overall Length	23'
Body Length	20'
Inside Height	6' 8"
Inside Width	7' 1"
Outside Width	7' 4 1/2"
Total Wt. Equipped	3300 lbs.
Hitch Weight	300 lbs.



THE Rocket

27'

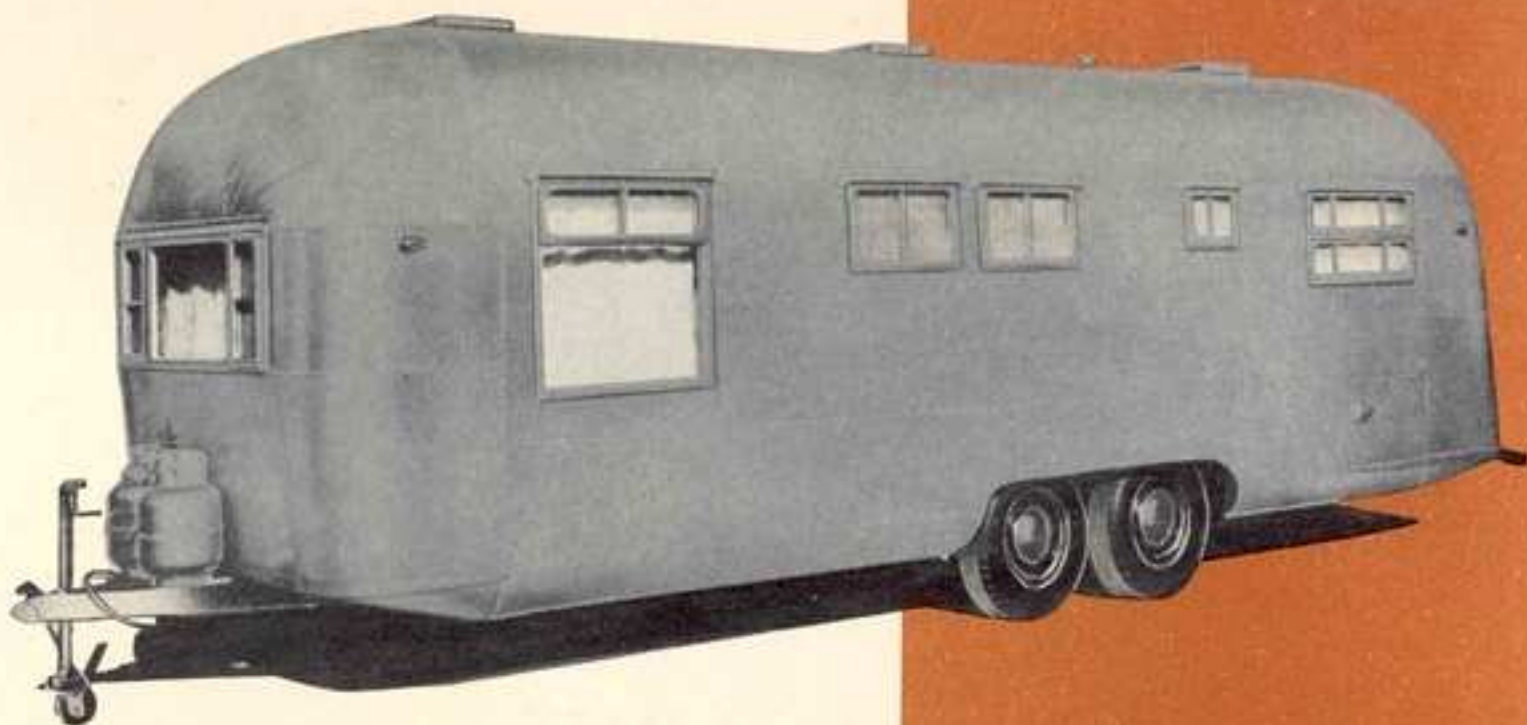

STANDARD EQUIPMENT

<p>Twin beds or double bed with box spring and innerspring mattresses Divan with arms, dinettes, or chairs in front Drop leaf or 3-position table in front - formica top Space provided for TV Seven-foot living room Glass lined electric water heater — 6-gal. Recessed vented wall heater with automatic control Deluxe apartment size stove with clock and timer Double sinks Formica galley top 72" long Eight-foot electric and ice combination refrigerator All metal cabinets Inlay linoleum Glass-lined 14-gal. pressure water tank Extension shelves on back lockers</p>	<p>Power roof vent over stove, Toilet and lavatory Medicine cabinet Drapes with draw shades over sink Double butane tanks 19-foot awning rail Two 6-volt ceiling dome lights Grab rail with light Escape door in bedroom Outside compartment door 3" channel iron bumper Electric 2-wheel brakes with break-away switch or hydraulic Heavy duty wheels and 6-ply tires Built-in step Directional signal lights 110 volt waterproof outlet</p>
--	--



SPECIFICATIONS

Overall length	27'
Body length	24'
Inside height	6' 8"
Overall height	8' 9"
Inside width	7' 1"
Overall width	7' 4 1/2"
Overall wt. equip'd	4070 lbs.
Hitch weight	300 lbs.



THE Luxury Liner 31'

STANDARD EQUIPMENT

Twin beds or double beds with box springs and innerspring mattresses
 Divan with arms, dinettes, or upholstered chairs in front
 Space provided for TV
 Ten-foot living room
 Glass-lined electric hot water heater — 6-gal.
 Glass-lined 14-gal. pressure water tank
 Recessed vented wall heater (with automatic heat control)
 Deluxe apartment size stove with clock and timer
 Double sinks
 Formica galley top 72" long
 Eight-foot Deluxe refrigerator
 All metal cabinets
 Extension shelves on back lockers
 Shelves over front and back windows

Inlaid linoleum
 Four roof vents (three with power fans)
 Walk-through bath with tub and shower
 Medicine cabinet
 Drapes with draw shades over sink
 Double butane tanks
 23-foot awning rail
 Two 6-volt ceiling dome lights
 110-volt waterproof outlet
 Grab rail with light
 Two outside doors complete with screens
 Outside compartment door in rear
 Three-inch channel iron bumper
 Electric 4-wheel brakes with break-away switch or hydraulic
 Heavy duty wheels with 8-ply tires
 Built-in step
 Directional signal lights

SPECIFICATIONS

Overall length 31'
 Body length 28'
 Inside height 6' 8"
 Overall height 8' 9"
 Inside width 7' 1"
 Overall wt. equip'd 4780 lbs.
 Hitch weight 350 lbs.
 Overall width 7' 4 1/2"



6" Steel Channels
(on 18" centers)

State Approved Plumbing

Steel Channel Iron
3" on Jet
4" on all other models

5/8" Plywood Flooring

Heavy Duty Axle
Assembly on all Models

Spun Glass Insulation
Top and Bottom

Steel Structural Member
Webbed in for added strength

ALL MODELS CARRY STATE APPROVED PLUMBING

Undercarriage completely concealed with an all metal riveted underskin for protection.

Special method of insulating trailer frames and wheel boxes.

All models have a double insulation in floor—one on top of floor channels and one on bottom. Metal wheel housings have insulation over top, then covered with 5/8" plywood box.

BODY CONSTRUCTION

The body of the SILVER STREAK TRAILER is two complete metal shells one inside the other, separated by a blanket of plastic treated fibre glass insulation, riveted together as one unit on extruded aluminum stretch formed bows and stringers. The only wood used in construction is the 5/8" plywood floor and cabinet doors.

Electrical wiring used in all models is 12-gauge Romex wire with 10-gauge from electrical inlet to breaker box. Breaker boxes vary with trailer sizes.

Outside skin is of 24ST Alclad Aluminum. Inside skin and cabinets are all metal of our own unique design for lightness. Door headers and frames are also stretch formed from extruded aluminum "Z" sections.

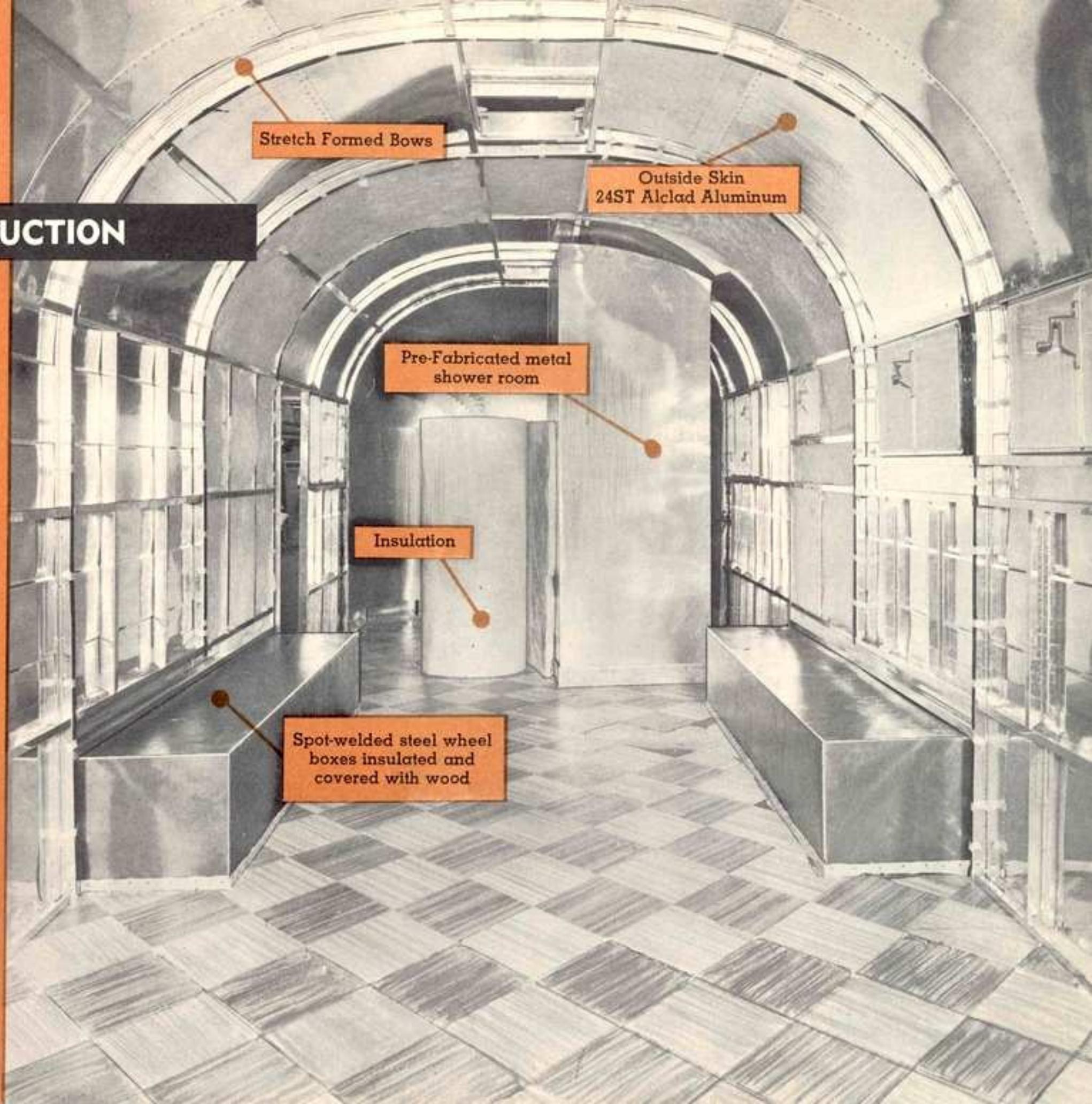

Stretch Formed Bows

Outside Skin
24ST Alclad Aluminum

Pre-Fabricated metal
shower room

Insulation

Spot-welded steel wheel
boxes insulated and
covered with wood

SILVER STREAK

TRAILER COMPANY

2319 N. Chico

• El Monte, Calif. •

Telephones: GILBERT 4-2646 and
CUMBERLAND 3-6372

DEALER:



Interior view of 27 ft. Rocket, looking aft.
Note the spacious galley.



Prefabricated aluminum
cabinets. A feature of SILVER
STREAK TRAILERS installed
by qualified men.

- Specifications subject to change without notice -

SILVER STREAK TRAILER CO.

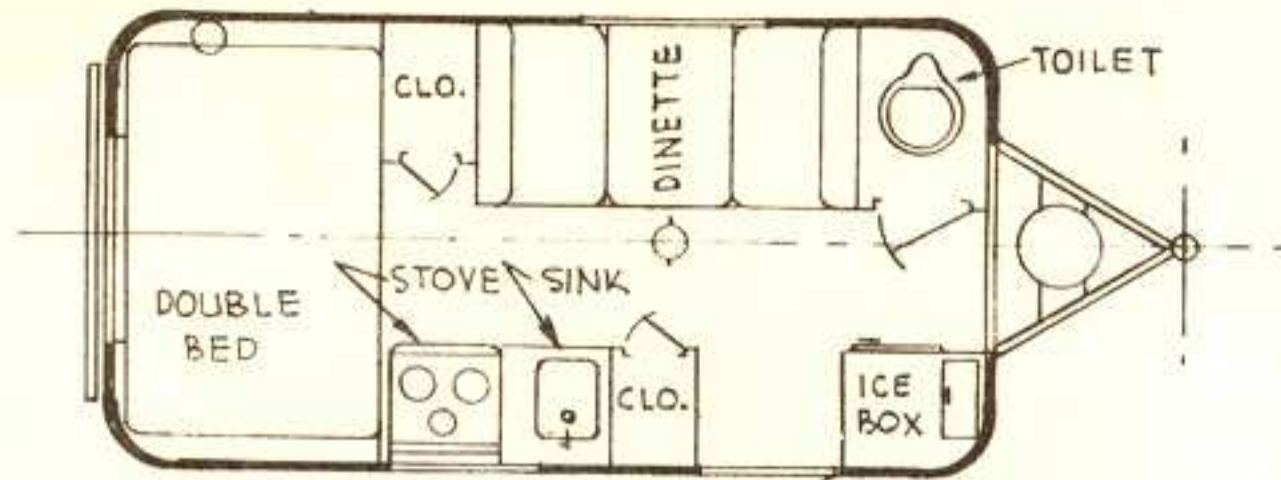

17' CHICO

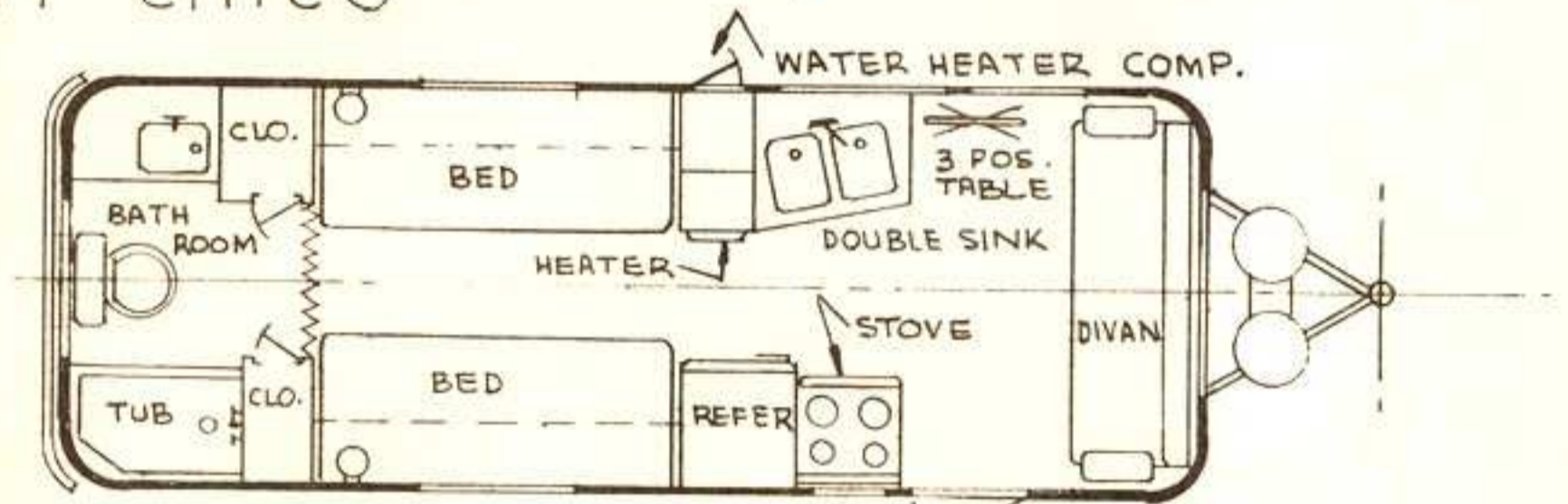

23' CLIPPER

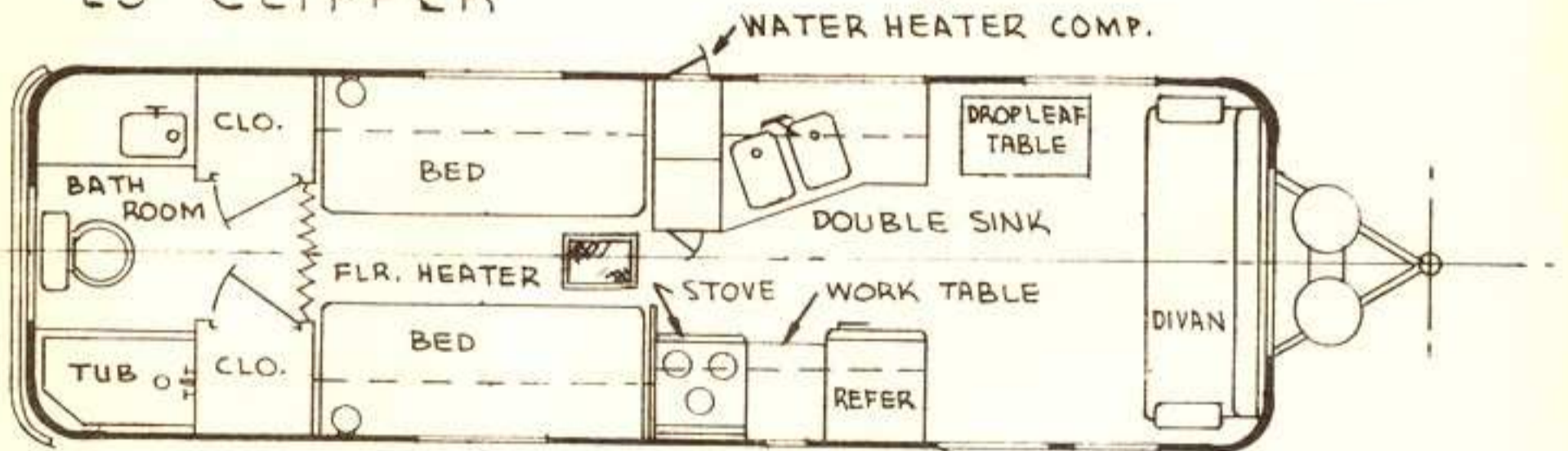

27' ROCKET

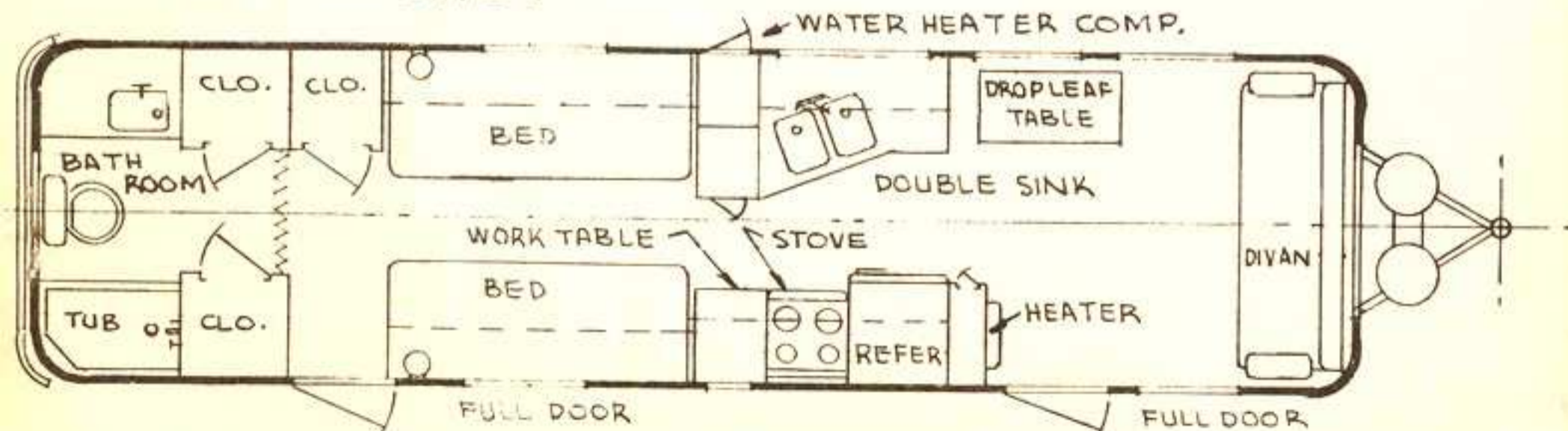

31' LUXURY LINER